

GYRATORY SIFTER MOUNT

TYPE CE

The RESATEC gyratory sifter mount type CE enables the mounting of hanging and standing gyratory sifters, as well as standing gyratory sifters with eccentric forced guidance. The pairing of two elements in one support enables a circular and plane oscillating movement. Although RESATEC type CE gyratory sifters are tear and break resistant, CE safety guidelines must be taken into account for hanging installations.

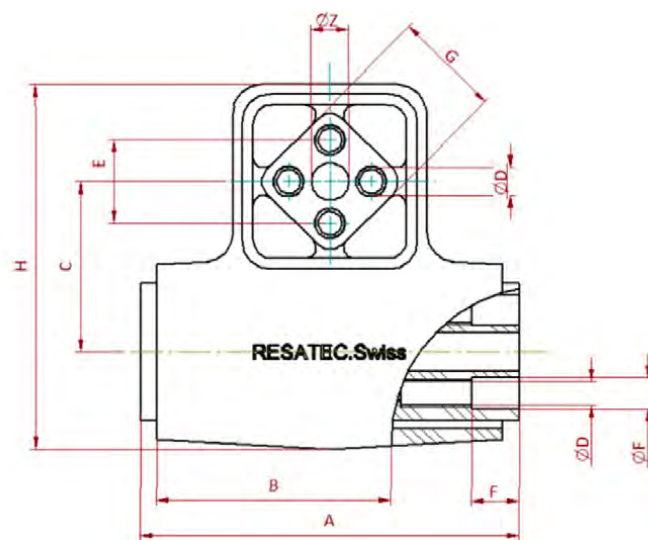

GYRATORY SIFTER MOUNT

TYPE CE

type	H	A +/- 0.3	B	C	øD	F	G	øF	øZ	weight kg	material		
											housing	core	
					+0,5 0								
CE 4 – 80	64	85	80	32	6	-	18	-	-	0.6	EN GJS 400 ISO 8062-3-DCTG11	Stahl mit Pulverlackierung	Aluminium
CE 5 – 100	97	105	100	45	8	-	27	-	-	1.7			
CE 6 – 120	130	130	120	60	10	-	38	-	-	3.6			
CE 7 – 150	154	160	150	72	12	-	45	-	16	6.6			
CE 8 – 200	172	210	200	78	M12 x 30	25	50	12.5	20	10.8			
CE 9 – 300	218	310	292	100	M16 x 40	70	60	16.5	-	35.2	Stahl SN EN ISO 13920 AE	Stahl mit Pulverlackierung	Stahl
CE 11 – 400	280	410	392	136	M20 x 40	70	80	20.5	-	72			
CE 12 – 400	340	410	390	170	M 24 x 50	70	100	25	-	107			
CE 12 – 500	340	510	500	170	M 24 x 50	70	100	25	30H7 x 30	135			

load values, capacity limits

type	load upright version crank shaft driven	load upright version unbalanced shaft driven	load hanging version	max. excitation speed n _{err} @ max. oscillating angle +/- 5°	suitable brackets
	Typ	N	N	min ⁻¹	type
CE 4 – 80	300	190	375	800	MA 3 - 4
CE 5 – 100	750	470	900	780	MA 4 - 5
CE 6 – 120	1500	940	1875	780	MA 5 - 6
CE 7 – 150	2800	1750	3500	580	MA 6 - 7
CE 8 – 200	5500	3400	6800	400	MA 7 - 8
CE 9 – 300	9500	5900	11800	300	-
CE 11 – 400	18000	11250	22500	150	-
CE 12 – 400	32000	20000	40000	100	-
CE 12 – 500	36000	22500	45000	100	-

We recommend minimum screw quality 8.8.

From size CE 8 – 200 the use of shaft screws is recommended.

Same alignment of the elements on the structure and offset by 90° for the elements on the screen box.

In case of upright design, the centre of gravity must be below the connecting point of the mountings on the screen box.

The maximum angle of oscillation is +/- 5°, otherwise the center distance of the support must be extended.